

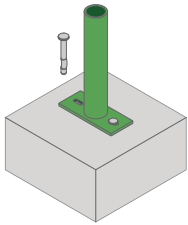

DERO STANDARD MOUNTING AND FINISH OPTIONS

MOUNTING OPTIONS



Surface Mount

For surface mounted racks a variety of anchors may be used depending on the installation surface material. Standard anchors are included in the cost of the rack, and tamper proof anchors may be purchased for an additional charge. Please contact us for more information about tamper proof options.

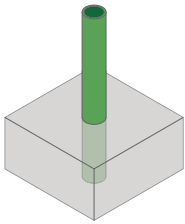

In-Ground Mount

In-ground mounted racks are embedded into a concrete base, approximately 6-10" below ground level.

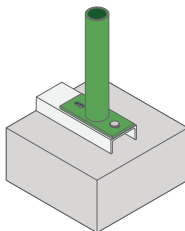

Rail Mount (Freestanding)

Bike racks mounted onto rails may be anchored to the ground for maximum security and easiest installation, or they may be left freestanding. This provides the greatest flexibility for placing racks on a variety of surfaces such as gravel and grass, where permanent anchoring is not an option.

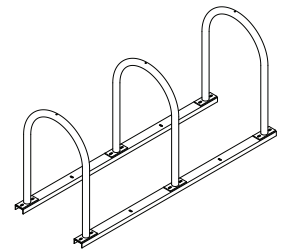

Tamper Resistant Fasteners

The concrete spike is a permanent anchor. The top of the wedge anchor can also be pounded sideways after installation so that it cannot be removed. Other tamper resistant fasteners are also available for purchase.



Breakaway Nut



Spanner Nut



Triple-slot Nut



Concrete Spike

FINISH OPTIONS



Hot Dipped Galvanized

Hot dipped galvanized is an extremely durable and low cost finish option. All of our bike racks are hot-dipped galvanized after fabrication and then hand ground to ensure a clean, safe surface. Unless otherwise noted, a hot dipped galvanized finish is included standard in the cost of all Dero products. We suggest using galvanized or stainless steel in locations where snow removal and corrosion are an issue.

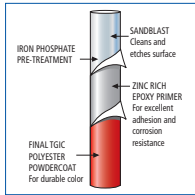

TGIC Powdercoat Finish

We offer over 250 high quality TGIC powder coated colors and specialize in matching color schemes. Our powdercoat finish starts with a sandblast treatment which cleans and etches the steel surface. The bicycle racks are then scrubbed and given an iron phosphate pre-treatment. An epoxy primer is electro-statically applied to ensure excellent adhesion to the base steel, and to protect the steel against corrosion and scratches. A final TGIC powdercoat is electro-statically applied and baked on to give the rack the final color and an additional layer of protection.

White	Black	Light Gray RAL 7042	Deep Red RAL 3003	Yellow RAL 1023
Bright Yellow	Orange RAL 2004	Blue RAL 5005	Sky Blue RAL 5015	Hunter Green RAL 6005
Light Green RAL 6018	Green RAL 6016	Sepia Brown RAL 8014	Bronze	Silver 9007



Stainless Steel

Stainless steel is the most beautiful and durable option. We use a 304 grade stainless steel which will continue to look new and attractive for many years.

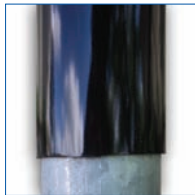

PVC Dipped Coating

Dero offers a rubbery, durable PVC coating in a range of colors on many models of bike racks. A rust-inhibiting pre-treatment is applied to the underlying steel before being dipped in UV-stabilized PVC. The coating is subsequently cured to produce a colorful coating that offers excellent protection against abrasion, impact, and corrosion. The PVC coating can be applied to galvanized racks to provide an even greater level of corrosion protection. Due to the special pre-treatment, the coating will not peel off the rack even if it is slit with a knife.

Black is the standard color for PVC dipping. We can also match hundreds of Pantone colors, Contact us for minimum order requirements and availability.



Thermoplastic Coating

Surface preparation for applying a thermoplastic finish is the same as is done with powder coating. Unlike powder coating, no primer is required. The thickness of the thermoplastic finish is more than powder coating, typically from 8 – 10 mils. In addition to an increased thickness, the thermoplastic finish offers superior impact resistance over powder coating.

Black	Blue	Green	Red	Gray	Brown
-------	------	-------	-----	------	-------